



Multi-Jet Meters

15 mm, 20 mm and 25 mm (5/8", 3/4" and 1")

Our Multi-Jets quietly perform to a high standard. Yours.

Millions of our 15 mm (5/8"), 20 mm (3/4"), and 25 mm (1") meters are in operation today. Using superior measurement technology, these meters represent the perfect balance between accuracy, cost, and longevity. With sensitivity to measure water flowing as low as 1/8 gallon per minute and accuracy unaffected by common particulates and build-up that would freeze other types, you can count on a Multi-Jet.

Our meters are designed with the future in mind as well. Choose from the many optional devices and you can create a modular reading system that has no equal. Remote Read? We can handle that. Wireless? We make it almost too easy. These meters are ready to work for you.

BENEFITS & FEATURES

- Meets All AWWA Standards; NSF Certified
- Tamper Detection and Prevention
- Patented Frost Protection (option)
- High-Quality, Long-Life Parts
- Durable Basket Strainer Protects From Damage



TECHNICAL SPECIFICATIONS

AWWA Standard	Meets or exceeds all sections of AWWA Standard C-708, most recent revision; Certified by NSF to NSF/ANSI Standard 61.	Register Sealing	Direct read and DIALOG registers are permanently sealed, with a tempered glass lens, stainless steel base and wrap-around gasket to prevent intrusion of dirt or moisture.
Design/Operation	Velocity-type meter. Water, evenly distributed through multiple inlet ports, flows past an impeller in the measuring chamber, creating an impeller velocity directly proportional to water flow rate. The meter's register integrates velocity into totalized flow.	Register Units	Registration available in U.S. gallons, cubic feet or cubic metres.
Main Case	Choice of waterworks bronze case of 81% copper composition or EnviroBrass® II, 87% copper, low lead bronze. All main cases incorporate externally threaded ends and wrench pads to aid installation. Bronze register retaining rings are standard.	Test Circle	Center mounted indicator with high sensitivity resulting from direct one to one linkage to the measuring element.
Measuring Chamber	The measuring chamber housing and measurement element are constructed of a durable synthetic polymer and can easily be removed from the main case without removal of the meter from the line. The chamber housing is constructed in two parts to allow access to the impeller. Measurement surfaces are not wear surfaces, providing sustained accuracy despite the presence of entrained solids in the water. A long-life, sapphire serves as a wear surface, with balanced water flows minimizing bearing wear.	Low Flow/Leak Indicator	Center mounted indicator with high sensitivity resulting from direct one to one linkage to the measuring element.
Magnetic Drive	A reliable, direct magnetic drive provides linkage between measurement element and register. No intermediate gearing is required; no gearing is exposed to water.	Strainer	A rugged, 360-degree polymer basket strainer protects the critical measuring element from damage.
Register	Standard direct read, DIALOG® Reading System and Electrical Output Registers are available. A six wheel odometer is standard.	Frost Protection (option)	Patented, pressure-activated plug is expelled from the meter by expansion of freezing water. The frost plug can be replaced without meter removal or disassembly.
		Adjusting Port	Sealed after factory calibration. Port is accessible for utility recalibration, to compensate for inaccuracy in older meters without parts replacement.
		Tamper Detection	The Master Meter Multi-Jet adjusting port is sealed to prevent tampering and provides a visual indication of tampering attempts.

Multi-Jet Meters - 15 mm, 20 mm and 25 mm (5/8", 3/4" and 1")

Characteristic	TECHNICAL DATA - US UNITS							TECHNICAL DATA - INTERNATIONAL UNITS						
	Unit of measurement	5/8"	5/8 x 3/4"	3/4" short	3/4" full	3/4" x 1"	1"	Unit of measurement	15 mm	15 x 20 mm	20 mm short	20 mm full	20 x 25 mm	25 mm
Flow Rating	U.S. gpm	20	20	30	30	30	50	m ³ /h	4.5	4.5	6.8	6.8	6.8	11.4
Continuous Flow	U.S. gpm	15	15	20	20	20	30	m ³ /h	3.4	3.4	4.5	4.5	4.5	6.8
Normal Operating Range (100% @ ± 1.5%)	U.S. gpm	1 - 20	1 - 20	2 - 30	2 - 30	2 - 30	3 - 50	m ³ /h	.23 - 4.5	.23 - 4.5	.46 - 6.8	.46 - 6.8	.46 - 6.8	.68 - 11.4
Low Flow (100% @ ± 3%)	U.S. gpm	.25	.25	.5	.5	.5	.75	m ³ /h	0.06	0.06	0.11	0.11	0.11	0.17
Maximum Working Pressure	psi	150	150	150	150	150	150	kPa	1034	1034	1034	1034	1034	1034
Maximum Working Temperature	°F	122	122	122	122	122	122	°C	50	50	50	50	50	50
Length (A below)	in	7.5	7.5	7.5	9	9	10.75	mm	191	191	191	229	229	273
Width (B below)	in	4.5	4.5	4.5	4.5	4.5	4.5	mm	4.5	4.5	4.5	4.5	4.5	4.5
Width, side-mounted DIALOG unit	in	3.75	3.75	3.75	3.75	3.75	4.13	mm	95	95	95	95	95	105
Height, standard register with lid (C below)	in	4.13	4.13	4.13	4.13	4.13	3.88	mm	105	105	105	105	105	99
Height, DIALOG register	in	4.88	4.88	4.88	4.88	4.88	4.63	mm	124	124	124	124	124	118
Height, bottom to center line (D below)	in	1.19	1.19	1.19	1.19	1.19	1.19	mm	30	30	30	30	30	30
Meter Casing Spuds, Nominal Thread Size (E below)	in	.75	1	1	1	1.25	1.25	mm	19	25	25	25	32	32
Weight	lb	4	4	4	4.25	4.25	5	kg	1.8	1.8	1.8	1.9	1.9	2.3
Packed to carton	units	6	6	6	6	4	4	units	6	6	6	6	4	4
Carton weight	lb	50	50	50	35	35	41	kg	10.9	10.9	10.9	11.6	7.7	9.1

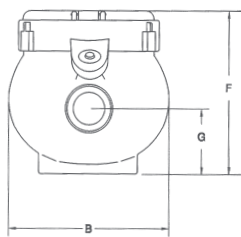
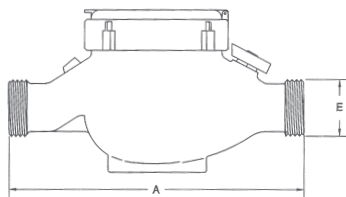

Frost Proof 5/8" to 1"

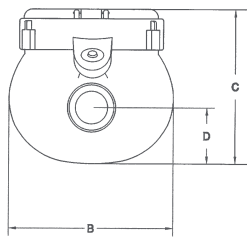
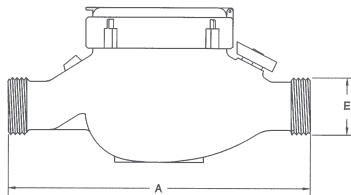

Standard 5/8" to 1"

Distributed by:

©2005 Master Meter, Inc. All rights reserved. DIALOG and Master Meter are registered trademarks of Master Meter, Inc. Master Meter reserves the right to make modifications to the products described herein at any time and without notice. U.S. Patent No. 6,819,292, Patent No. 6,954,178. Others pending. EnviroBrass® is a registered trademark of ASARCO.

MMDS MJ-58341_CEN Rev14/09/06



Master Meter Canada • 100 Lansdowne Street, Suite 207 • St-Bruno, Québec J3V 0B3
Toll free: 1 866 761-1535 • Phone: (450) 461-1535 • Fax: (450) 461-3720

www.mastermeter.ca
infocanada@mastermeter.com